

# USER MANUAL

## SPATOUCH 2

# Contents

<b>1</b>	<b>Hot tub performance specifications</b>	<b>3</b>
<b>2</b>	<b>Preparation for the installation of the hot tub</b>	<b>4</b>
2.1	Preparation of the place for installation and connection to electricity	4
2.2	Preparation for the interior hot tub installation	5
2.3	Preparation for the exterior hot tub installation	5
<b>3</b>	<b>Installation of the hot tub</b>	<b>5</b>
3.1	General information	5
3.2	Filling the hot tub with water	6
3.3	Running the power supply of the hot tub	6
3.4	Programming of the hot tub control unit using the control panel	6
<b>4</b>	<b>Aquatic AV audio system</b>	<b>6</b>
<b>5</b>	<b>Control panel</b>	<b>7</b>
5.1	Main information on display	7
5.2	Navigation	7
5.3	Filter cycles	7
5.4	Time	8
5.5	Temperature	8
5.6	Blower	9
5.7	Lighting	9
5.8	Jets	10
5.9	Display rotation	10
5.10	Other settings	10
5.11	Lock	11
5.12	Hold-on mode	12
5.13	Information	12
<b>6</b>	<b>Trouble shooting</b>	<b>12</b>
<b>7</b>	<b>Upkeep of the hot tub</b>	<b>16</b>
7.1	General information	16
7.2	Removal and cleaning of the filter cartridge	16
7.3	Maintaining the quality of the water in the hot tub	17
7.4	Replacing the water	18
7.5	Cleaning the outer shell of the hot tub	18
7.6	Hot tub hygiene and disinfection	18
7.7	Thermo cover	18
7.8	Upkeep of the thermo cover and upkeep instructions	19
<b>8</b>	<b>Winter and summer time</b>	<b>19</b>
8.1	Winter time – using the hot tub, all year operation (SLP)	20
8.2	Summer time	20
<b>9</b>	<b>Final establishments</b>	<b>20</b>
9.1	Guarantee conditions	20
9.2	Safe disposal of the product after the service life	20
9.3	Warranty claims and repair services	20
<b>10</b>	<b>Repair services chart</b>	<b>21</b>
<b>11</b>	<b>Supplements</b>	<b>21</b>
<b>12</b>	<b>Notes</b>	<b>22</b>

# Hot tub performance specifications

For your own safety and the safety of your product, please observe the following instructions. Read the following information carefully and follow the user manual exactly when using the hot tub to avoid damaging the product or the risk of injury. This appliance is intended for use by children 8 years of age or older with reduced physical, sensory or mental capabilities, or lack of experience and knowledge, provided they are under supervision or have been instructed on the use of the product and understand the risks. Children must not play with the product. Cleaning and maintenance must not be performed by children without supervision.

## 1 Hot tub performance specifications

### Performance specifications

rated voltage:	three-phase connect. 230/400 V 50 Hz*
maximum working current:	3 × 16 A
current surge:	up to 3 × 25 A
voltage resistance:	1 250 V/min. without breakdown
insulation resistance:	≥ 1 M Ω
water resistance (protection):	IPX5
electrical shock protection:	first degree

\*The product does not use 400 V phase to phase voltage. It is possible to adjust it to 1 × 230 V; however, this is not recommended due to limitation of the functions. (For more information on this connection, please refer to the Supplements, p. 21)

### Load capacity

heating:	1 × 230 V/3 kW/13.6 A
ozone:	1 × 230 V/50 Hz/80 mA
blower:	1 × 230 V/0.66 kW/2.9 A
pump 1/1 + 1/1 + 0,4:	2.2 kW + 2.2 kW + 0.4 kW
total input power (depending on type of hot tub):	8.5 kW/h
protection class:	I.
lighting:	LED 12 V AC/10 W
maximum output power:	20 W

### Preparation and electrical connection options – AC three-phase current 3 × 230/400 V/16 A/20 A

Ensure that the hot tub is always connected to a circuit protected by a Residual Current protective Device with a rated tripping current of 0.03 A. It is necessary to use a Type C or Type D circuit breaker with a rated current of 16 A (motor circuit breaker) downstream of the Residual Current protective Device.

# Preparation for the installation of the hot tub

## Recommended Type C circuit breaker

Hot tubs with two massage motors:

3× 16 A/C or D

Hot tubs with three massage motors:

3× 20 A/C or D

**!!!THE HOT TUB MUST ONLY BE CONNECTED BY A PERSON WITH PROFESSIONAL ELECTRICAL QUALIFICATION IN ACCORDANCE WITH DECREE NO. 50/1978 COLL.!!!**

## 2 Preparation for the installation of the hot tub

**Check the hot tub before use! If any part of it is damaged or missing, immediately contact the retailer without delay! Ensure that all components are in line with your order. Check the hot tub every time before use. In case of any damage, do not use the hot tub! In case your spa is equipped with screwless cabinet, it is prohibited to install additional accessories or load the cabinet in a way not specified by the manufacturer. Damage caused by failure to follow this precaution is not covered by the warranty!**

### 2.1 Preparation of the place for installation and connection to electricity

The hot tub must be installed on a flat, sufficiently solid base plate, taking into account the load-bearing capacity of the building. If the hot tub is installed outdoors, we recommend constructing a concrete monolithic base slab with a minimum strength (thickness) of 10 cm. It is important to also always select the load-bearing capacity of the base slab with regard to the dimensions and the weight of the hot tub. Consult your building supervisor. The weight is specified in the technical description of the given hot tub. The tubs are prepared by us for an electrical connection of 3× 230 V/400 V~ alternating current. Therefore, use a circuit breaker 3× 16 A/C or D, alternatively 3× 20 A/C or D and a Residual Current protective Device corresponding to this connection. Furthermore, it is necessary to have a cable with parameters corresponding to the rightful regulations for this type of connection. **The cable must also have 4 usable meters at the location of the hot tub**, so that it can be pulled through and connected to the control unit without complications. Do not route the cable under the hot tub!

YES

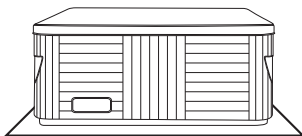

NO

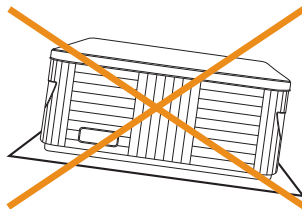

## 2.2 Preparation for the interior hot tub installation

If the hot tub is installed in an interior space, it is necessary to comply with safety instructions. The basic safety requirements are mainly non-skid floors and drainage in the place of the installation in case of a water overflow. It is also crucial to keep in mind that the humidity around the hot tub will rise and can damage surrounding electric appliances. Therefore we recommend customizing the place of the installation according to these conditions. **The hot tub should be accessible from all sides for future repair services.** If it is not sufficiently accessible during the guarantee period, the owner has a duty to ensure the access.

## 2.3 Preparation for the exterior hot tub installation

If the hot tub is installed in an exterior space, it is necessary to comply with safety instructions. The basic safety requirements are mainly non-skid floors and water drainage in case of a rainfall or water overflow from the hot tub. Therefore we recommend customizing the place of the installation according to these conditions.

# 3 Installation of the hot tub

**Warning: connection to electricity must be done according to norms valid in Czech Republic ČSN 33 2000-7-701**

## 3.1 General information

We strongly recommend you to hire professionally trained and qualified technicians for the process of installation. If you decide to install the hot tub by yourself, please abide by the following instructions.

- a) Carefully remove all the packaging material from the hot tub and position the hot tub on a beforehand selected place of installation.
- b) Demount the front panel on the side of the hot tub control panel. Demount the upper cover of an electrical wiring under which you can find a residual current device, a ground fault circuit interruptor (if it is part of the hot tub equipment) and a ground staple. The connection itself must be done by a person with an expert qualification.
- c) Every hot tub is tested in real life conditions during the production process, therefore there is a possibility some technical parts of the hot tub have remained slightly dirty. We recommend you to clean the surface of the hot tub using a suitable method; lukewarm water works best for this purpose. Clean the surface using a soft cloth only. Don't use any rough abrasive means and cloths which could permanently damage the surface of the hot tub. If you decide to use a generic cleaning detergent, it cannot be aggressive towards the hot tub surface.
- d) Before filling the hot tub, make sure that all the screws on the equipment are tightened to prevent water leakage.

## 3.2 Filling the hot tub with water

Fill the hot tub with a sufficient amount of water. The level of water in the hot tub cannot ever fall under the skimmer level. If you notice a water leak, stop the water until the defect is fixed. Hot tubs do not possess the technology for water-softening and hard water can be damaging to them. The damages caused by poor handling and upkeep are not covered by the guarantee.

- a) Fill the hot tub through a skimmer to prevent an over aeration of the circulation pumps.
- b) Do not fill the hot tub with water of temperature over 104 °F.
- c) Once the water reaches the desired level, put the cartridge filter inside the skimmer. Tilt the filter during the installation to prevent air bubbles. Only after removing the air from the filter, install the filter into place.

## 3.3 Running the power supply of the hot tub

If the hot tub is connected by a moving supply cable, this cable cannot come in contact with sharp objects or be exposed to external forces. Therefore we recommend putting the supply cable inside a protective case. Turn on a residual current device intended for a hot tub.

## 3.4 Programming of the hot tub control unit using the control panel

Now you can start the programming of the hot tub. The process is described in the chapter "Control panel". After you are finish the programming, cover the hot tub with a thermo cover and let the water temperature to stabilize. Check the water level inside the hot tub regularly.

# 4 Aquatic AV audio system

**Aquatic AV audio system AQUATIC/MY MUSIC** (relevant only for hot tubs equipped with the system)

If you want to play music from an external device, it is necessary to pair the device with the hot tub first (phone, tablet, computer). Turn on the bluetooth system on your external device and search for the AQUATIC device. The connection is not restricted by a code and only one connection can be active at a time. You can play music immediately after the devices are successfully paired. You can control all the functions of the audio system on your connected external device.

## 5 Control panel (BALBOA SpaTouch 2)

### 5.1 Main information on display

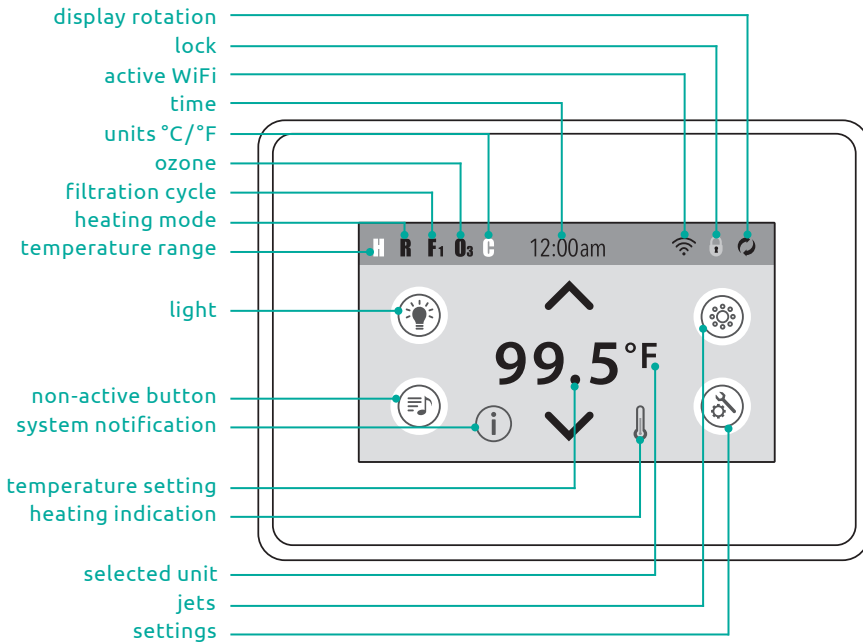

### 5.2 Navigation

Navigating the entire menu structure is done using the touch screen of the control panel. The panel settings are adapted to the parameters set in the control unit.

### 5.3 Filter cycles

You can access this function by pressing the *setup* button on the main screen. Then select the *filter* from the menu. Two filter cycles are available.

#### a) Filter cycle 1

The filter cycles are set using the start time and the end time. The display calculates the filtration time and displays it automatically. Set the time when the cycle should start and the end time.

# Control panel

## b) Filter cycle 2

Filter cycle 2 is off by default. If you want to turn it on, simply go to the line *Filter Cycle 2* and set it in the same way as Filter Cycle 1.

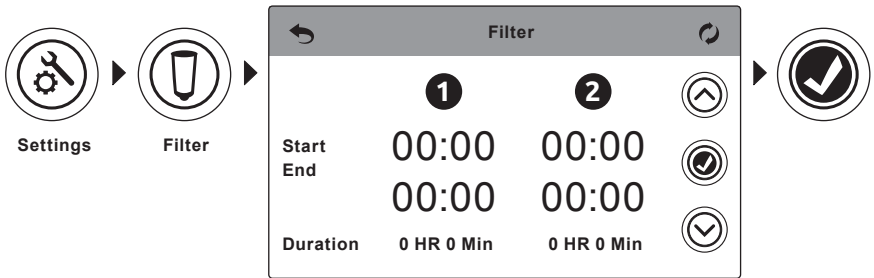

Set the filter cycles so that one works in the morning and the other in the afternoon, at least two in the morning and two in the afternoon, depending on the water quality and whirlpool capacity.

## 5.4 Time

Setting the time is important for the whirlpool to function. From the main screen, touch *Settings*. In the next selection, select the *Time* button. To adjust the values, touch the hours and minutes when the value you just changed changes color. Use the arrows on the right to adjust the marked value. After setting, press the confirmation button between the arrows. Use the up and down arrows to easily change the hour, minute, or 12/24 hour settings.

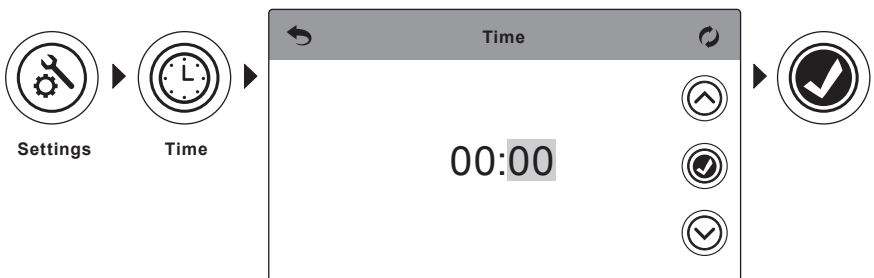

## 5.5 Temperature

The temperature is displayed in the center of the main screen. You can change the setting with the arrow above and below the temperature. (see picture on the next page)



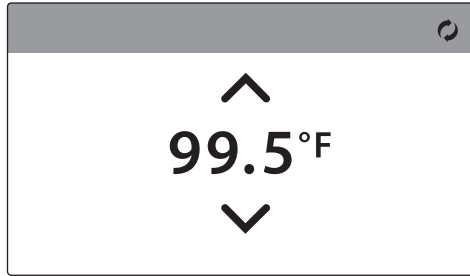

a) **Heating mode**

ready

economical

**in this mode the whirlpool heats the water to the set temperature**

**in this mode the whirlpool only heats the water at the time of filtration**

b) **Temperature range**

high

**79.88–104 °F**

low

**50–98.6 °F**

## 5.6 Blower

Select the nozzle button on the main screen. Press blower in the following menu. When the function is active, the button is highlighted.

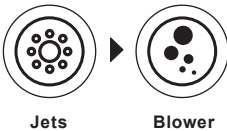

## 5.7 Lighting

This function is on the main screen. It can also be found in the following way: On the main screen, select the nozzle button. Press the light button in the following menu. When the function is active, the button is highlighted.

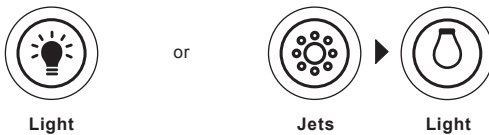

## 5.8 Jets

Select the *jets* button on the main screen. Select the *jets* in the following menu (the number and function of the buttons depends on the settings of the control unit and the whirlpool equipment). If the function is active, the button is highlighted. The intensity at which the pump is on is represented by the wheels that circulate the button around the wheel. If the whirlpool is equipped with two speed pumps, the button has two levels, the first circulates two wheels for circulation and four at the start of the massage circuit. In case the whirlpool has only one-speed pumps, there is a possibility to switch the pumps *on* or *off*.

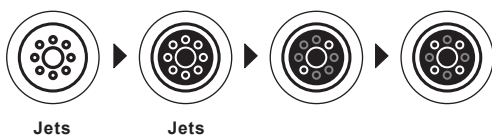

The water flow rate through the nozzles can be adjusted by turning the nozzles to the left or right. Therefore, if water is not flowing through the nozzle, it may not be a malfunction; the nozzle may only be closed. Not all nozzles can be regulated in this way.

It is also possible to regulate the power of the massage while the massage engine is running by turning the air intake valve at the top of the whirlpool.

## 5.9 Display rotation

On the main screen, in the upper right corner, there is a button to rotate the display.



## 5.10 Other settings

This menu allows the user to change certain parameters according to their preferences: Temperature switching between Celsius and Fahrenheit. From the main screen,

press the *setup* button, then press the *right arrow*. In this menu, you can set, for example, the temperature and time units, the language, or the control panel sleep timer.

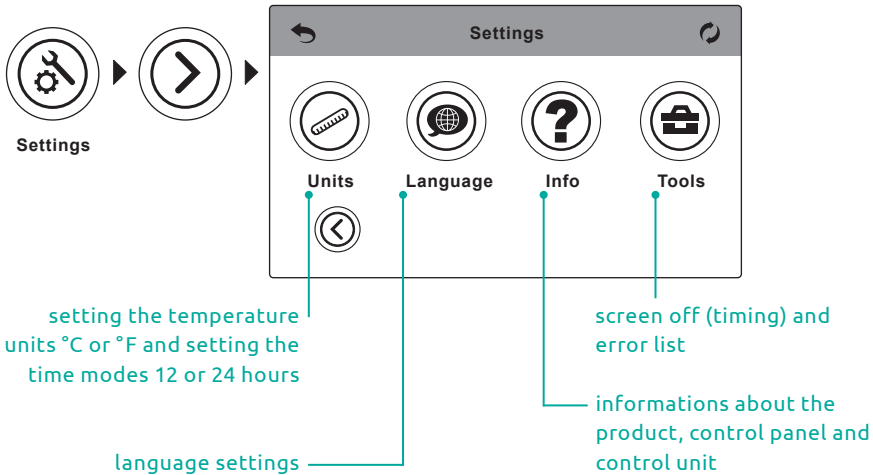

## 5.11 Lock

The user can independently lock the display or all settings. Locking the settings restricts control. Locking allows the use of jets and the set functions are still active. To lock, select the settings button on the main screen. Press Lock. The setting options/panel are displayed. Touch to select whether to lock the settings or the entire panel. When you press the option, the lock settings/panel is displayed at the bottom. Press the lock function on the top bar and hold it for 5 seconds. The locked option is highlighted with a text lock below it. To unlock, select the locked option and press the lock button on the top bar again, hold for 5 seconds and the function will unlock.

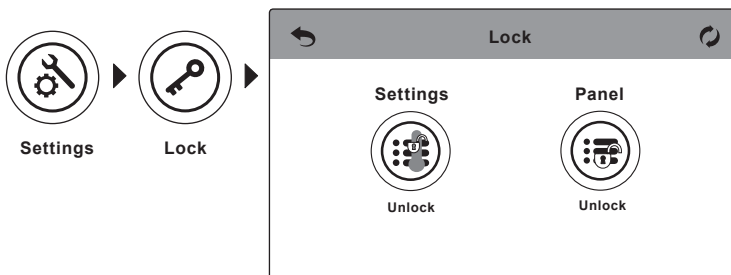

# Control panel/Trouble shooting

## 5.12 Hold-on mode

The hold mode is used to disconnect the pumps during servicing, such as cleaning or filter replacement. Hold mode will last for 1 hour unless canceled manually. If it takes more time to service the spa, it is better to turn off the power to the spa.

## 5.13 Information

The system information menu displays various settings and identification of a particular system. Since each menu item is highlighted, the detail of this item is displayed at the bottom of the screen. You can find it in the settings section 2 under the title *info*.



Settings

Info

*Software ID (SSID)*  
*system*

*current settings*

*heating power input*

*heating type*

*DIP switch setting*

*display version*

shows the software ID of the system

shows the system model number

displays information for button configuration (service)

shows operating el. the voltage that is configured  
standard heating

shows the number that represents the positions of the  
fuse line S1 on the main distribution board

shows the software number in the top control panel

# 6 Trouble shooting

Most of the messages show up in the lower left corner of the screen.

## GENERAL REPORTS

-- °F -- °C	<b>The water temperature is unknown</b> The current temperature will show up after 1 minute of the circulation pump running.
-------------	---

<p><b>conditions of possible freezing</b></p>	<p>Show up when conditions of possible water freezing are detected or the AUX freeze switch has turned off while the circulation pumps and jets are turned on. In some cases the circulation pumps can turn on and off and the heater can run in the freeze protection mode. This is an informative operational message, not a defect indicator.</p>
<p><b>M029</b></p>	<p><b>The water is too hot</b>          One of the temperature sensors detected a water temperature of 109.94 °F and the hot tub functions are disabled. The system will automatically rest once the water temperature falls under 107.96 °F. Check whether the circulation pump has been running for too long or the surrounding temperature is too high.</p>

## HEATER REPORTS

<p><b>M016</b></p>	<p><b>The water flow through the heater is reduced</b>          This report says that not enough water flows through the heater for the warmth from the heater to get effectively distributed. The heater will turn on again after approximately 1 minute. See below for "Checking the water flow".</p>
<p><b>M017</b></p>	<p><b>The water flow through the heater has failed</b>          This report says that not enough water flows through the heater for the warmth from the heater to get effectively distributed thus the heater has turned off. After resolving the problem, press any button to reset the heater and turn it on again.</p>
<p><b>M028</b></p>	<p><b>Apparently, there is no water flowing through the heater</b>          There is no or very little water in the heater for it to turn on. The hot tub will turn off for 15 minutes. Press any button to reset the heater. See below for "Checking the water flow".</p>
<p><b>M027</b></p>	<p><b>The heater is without a water flow</b>          There is not enough water in the heater for it to turn on. The hot tub is turned off. After resolving the problem, press any button to reset the heater and turn it on again. See below for "Checking the water flow".</p>
<p><b>M030</b></p>	<p><b>The heater is too hot</b>          One of the temperature sensors detected a temperature of 118.04 °F in the heater and the hot tub turned off. Press any button to reset the heater once the temperature falls under 107.96 °F. See below for "Checking the water flow".</p>

# Trouble shooting

## Checking the water flow

Check whether the water flow is not too low, whether there is an obstacle in the area of water suction, whether the valves are not closed, check for air pockets and too many closed jets. Some devices can occasionally turn on by themselves to enable temperature monitoring or requested freeze protection, even when the hot tub is turned off.

## SENSOR RELATED REPORTS

<b>M015</b>	<b>The sensor balance is off</b> The temperature sensor synchronization can be off by 60.98 °F up to 61.88 °F. Call the repair service.
<b>M026</b>	<b>The sensor balance is off</b> The sensors are not synchronized. The report is displayed longer than 1 hour. Call the repair service.
<b>M031 (A) M032 (B)</b>	<b>Sensor A failure, sensor B failure</b> Temperature sensor or electrical circuit sensor had failed. Call the repair service

## NON-CLASSIFIABLE REPORTS

<b>communication failure</b>	The control panel does not receive reports from the system. Call the repair service.
<b>test software</b>	<b>Test software is installed</b> Both the control system and the test system are running at the same time. Call the repair service.
<b>°T degrees</b>	<b>°F or °C are replaced by °T degrees</b> The control system is running in a test mode. Call the repair service.

## SYSTEM RELATED REPORTS

<b>M022</b>	<b>Memory failure – control fail summary</b> The programmed failure test has failed during the system start-up.
<b>M021</b>	<b>The setting were reset (permanent memory error)</b> Contact your seller or repair services if this report is displayed more than once during one start-up.
<b>M020</b>	<b>Timer failure</b> Contact your seller or repair services.

<b>hot tub will not turn on</b>	<b>Configuration failure (the hot tub will not turn on)</b> Contact your seller or repair services.
<b>M034</b>	<b>The circulation pump appears stuck</b> The water can be too hot. DISCONNECT THE HOT TUB FROM THE POWER SUPPLY. DO NOT ENTER THE HOT TUB. Contact your seller or repair services.
<b>M035</b>	<b>Heating failure</b> The circulation pump appeared stuck during the last time the hot tub was turned on. DISCONNECT THE HOT TUB FROM THE POWER SUPPLY. DO NOT ENTER THE HOT TUB. Contact your seller or repair services.

## REMINDER MESSAGES

<b>general upkeep</b>	<b>General upkeep help</b> Reminder messages can be suppressed in the PREF. menu. Reminder messages can be individually selected by the producer. They can be cancelled altogether or a restricted amount of reminders is allowed for a specific model. The frequency of each reminder (for example 7 days) can be specified by the producer in advance.
<b>pH control</b>	Shows up regularly, for example once every 7 days. Check the water pH level with a testing kit and adjust the pH level by the suitable water chemicals.
<b>disinfection control</b>	<b>Check the disinfection</b> Can show up regularly, once every 7 days. Check the disinfection and other water chemicals level and adjust it by suitable chemicals.
<b>clean the filter</b>	Can show up regularly, once every 30 days. Clean the filter according to the producer instructions. See pg. 12 for "Hold-on mode".
<b>GFCI test (or RCD)</b>	Shows up regularly, for example once every 30 days. GFCI – ground fault circuit interrupter or Residual Current Device (RCD) are important safety devices, which have to be regularly tested to check their reliability. Every user should know how to run a safety GFCI or RCD test related to the installation of the hot tub. GFCI or RCD have TEST and RESET buttons to enable the user to test their proper functionality.
<b>replace the water</b>	Shows up regularly, for example once every 90 days. Replace the water regularly to keep the hot tub water chemically balanced and hygienic.
<b>clean the cover</b>	Shows up regularly, for example once every 180 days. The vinyl covers should be cleaned and treated to keep their maximum longevity.

# Trouble shooting/Upkeep of the hot tub

<b>treat the wooden surface</b>	Shows up regularly, for example once every 180 days. The cabinet and wooden equipment of the hot tub should be cleaned and treated according to the producer instructions to keep their maximum longevity.
<b>change the filter</b>	Shows up regularly, for example once every 365 days. The filters should occasionally be replaced to ensure a proper functionality of the hot tub and good hygiene.

## 7 Upkeep of the hot tub

### 7.1 General information

Do not expose the hot tub to sun without water inside or a cover on top. The direct sunlight can cause fading and deformation of the surface material. When you are not using the hot tub, cover it with the thermo cover, regardless of whether it is empty or full. Protect the hot tub from rain and snow. Place the hot tub under a gazebo or a roof if possible.

- Do not open the control unit. There are no user-fixable parts inside.
- Drain, clean and fill the hot tub with clean water on regular schedule.
- Clean the filter cartridge at least once a week.
- The hot tub user should have a proper shower before and after the use of the hot tub.

### 7.2 Removal and cleaning of the filter cartridge

The hot tub filter cartridge can get clogged by calcareous and mineral particles from a hard water, which can lead to a restricted water flow inside the filtration system.

**We recommend to clean the filter cartridge at least once a week.**

Remove the cartridge and the skimmer insertion. Using a garden hose, clean the cartridge so that no settled dirt remains in the corners of the filter. Once clean, put the insertion back to the skimmer. Put the cartridge inside the skimmer tank next and close it. Remember that the filter cartridge has to be replaced every 3–6 months. Replace it even sooner if it is damaged or clogged, it is not usable in such state.

Make-up, sunscreens and other types of body lotion decrease the quality of the water and lower the filter cartridge longevity.



## 7.3 Maintaining the quality of the water in the hot tub

**WARNING: Always add the chemicals to the water, never the other way around. Add the chemicals to the water only when there are no people inside. Use the circulation pumps to mix the chemicals with the water. Store the chemicals according to the instruction on their label.**

- a) Use a suitable water hardness regulator regularly (the **HANSCRAFT SPA Water hardness regulator** is recommended) and follow the instructions on the chemicals' label.
- b) Depending on the frequency of use of the hot tub, test the water quality regularly by a suitable water quality tester.
- c) Adjust the water pH level accordingly by suitable water chemicals (the **HANSCRAFT SPA – pH PLUS** and **pH MINUS** is recommended).
- d) Adjust the Cl (chlorine) level with suitable water chemicals (**HANSCRAFT SPA – MULTI MINI 3 in 1 tablets** are recommended). Follow the instructions on the chemicals' label.  
**For the chlorine to have the desired effect, the pH level needs to be adjusted first.**
- e) We recommend you to clean/replace the filter cartridge before adding the chemicals.

**Chlorine shock** – in case of extreme pollution, it is necessary to treat the water with a dose of fast dissolving chlorine and thus perform a chlorine shock. The pH level of the hot tub water has to be adjusted to 7.0–7.6 first and the chlorine level has to be checked. Once a week or after adding a large amount of fresh water to the hot tub, add a shock dose of chlorine 10–20 g/m<sup>3</sup> (2 table spoons) into the water. Add the chlorine only when there are no people in the hot tub. After you add the chlorine, turn on the circulation pumps so that the chemicals mix well with the water. If you are using a granulated form of the chemical, dissolve it in a small amount of water first. Let the chlorine level drop to 3 mg/l before you start using the hot tub.

**Oxygen shock** – in case of extreme pollution, it is necessary to treat the water with a large dose of fast dissolving oxygen and thus perform an oxygen shock. The pH level of the hot tub water has to be adjusted to 7.0–7.6 first and the oxygen concentration in the water has to be checked. Once a week or after adding a large amount of fresh water to the hot tub, add a shock dose of oxygen (2 tablets) into the water. Add the oxygen only when there are no people in the hot tub. After you add the oxygen, turn on the circulation pumps so that the chemicals mix well with the water. Let the oxygen level drop to 15 mg/l before you start using the hot tub.

**Store the chemicals according to the instructions on the label.**

# Upkeep of the hot tub

## Ideal chemical levels

<b>Free chlorine concentration (active oxygen concentration)</b>	0.7–1.0 mg/l (10–15 mg/l)
<b>pH level</b>	7.0–7.6
<b>Calcium</b>	100–180 mg/l
<b>Overall alkalinity</b>	80–120 mg/l

## 7.4 Replacing the water

It is important to keep the hot tub water fresh and clean. We recommend you to replace the water at least every 3 months unless the water quality drops sooner. The hot tub water can be used for watering the garden for example, given that it has not been chemically treated at least one week prior.

- a) Disconnect the hot tub from the power supply (turn off the residual current device).
- b) Check the power supply cable and make sure it is not wet.
- c) Drain the water through a water drainage system, close it carefully and fill the hot tub with fresh water.
- d) Connect the hot tub back to the electrical circuit (turn on the residual current device).

## 7.5 Cleaning the outer shell of the hot tub

Use a mild, not abrasive cleaning detergent and a soft cloth.

## 7.6 Hot tub hygiene and disinfection

Taking care of hygiene is extremely important for elimination of any germs, algae and other harmful organisms polluting the water in the hot tub. Test the water using the testing kit first (to find out the pH and Cl level) and follow by using suitable water chemicals accordingly. Follow the instructions on the chemicals' label carefully.

## 7.7 Thermo cover

Using the thermo cover helps saving up energy expenditures by minimizing temperature loss and evaporation. The cover is an effective way of protecting your hot tub from impurities and fallen leaves.

# Upkeep of the hot tub/Winter and summer time

**WARNING: For safety and damage prevention reasons, do not sit, stand or lie on top of the cover. Do not place any objects on top of it. The thermo cover does not serve as a fence around the bathing area either. Do not let animals walk on top of the thermo cover. Prevent a large snow layer build up on top of the thermo cover.**

## 7.8 Upkeep of the thermo cover and upkeep instructions

It is important to take a proper care of the thermo cover: clean it when necessary and treat it with a product intended especially for an eco-leather or fake leather. The guarantee does not cover damages caused by an inappropriate cleaning product.

- a) The right balance of water chemicals represents an important factor in prolonging the longevity of your hot tub thermo cover.
- b) Remove the hot tub's cover and place it on the ground surface down.
- c) Wash the cover with a large amount of water from a garden hose or a water bucket.
- d) Clean the thermo cover surface using a soft brush and a mild dish soap solution (1 tea spoon of dish soap per 8 litres of water).

**Attention: Do not let the dish soap solution dry on the thermo cover before washing it off!**

- e) Wash off the cleaning solution thoroughly.
- f) Return the cover back on the hot tub.
- g) Open the thermo cover regularly so that the chemical vapours can disperse. Flip the thermo cover inner side up at least twice a year for 3–4 hours.
- h) If the thermo cover does not get regularly cleaned twice a month, the surface material can become frail or age prematurely. The seams can separate. If you do not clean the thermo cover appropriately, the guarantee becomes invalid.

**WARNING: Do not lift the thermo cover by the handles. A vacuum forms between the thermo cover and the hot tub therefore lifting by the handles could result in a damage. It is necessary to support the thermo cover from below by hand.**

## 8 Winter and summer time

**Winterizing the hot tub, a process recommended by the producer.**

It is required that all water gets drained from the hot tub during the process of winterizing it, as well as water from all the technical parts of the hot tub (circulation pumps, pipes, etc.) We recommend you to use our specialized service for this purpose because flawed winterizing of the hot tub can result in a loss of the guarantee.

# Winter and summer time/Final establishments

If you decide to use our professional services, it is necessary to order them sufficient amount of time in advance. In case of winterizing the hot tub by yourself, it is crucial to do it when the air temperature is still above zero. If the winterizing is done in temperatures below zero, it can be very difficult because water in the motors could have frozen already and damaged some parts of the hot tub.

## 8.1 Winter time – using the hot tub, all year operation (SLP)

If you decide to keep using the hot tub during the winter time, it is necessary to keep checking the hot tub for cases of for example: circuit break failure, motor not working, heating not working, filter cartridge getting clogged.

**If the instructions above are not complied with and it results in a damage of the hot tub, the warranty cannot be claimed.**

## 8.2 Summer time

Do not expose the hot tub to direct sunlight; do not use inappropriate cleaning detergents for upkeep. Prevent the hot tub surface coming in direct contact with chemicals as well as surface scratches cause by sharp objects. Ensure the safety of children in the hot tub by a continuous adult supervision. Only eligible persons over 18 years of age, educated about the whole process, can be operating the hot tub. The same goes for handling the water chemicals, which have to be stored out of children's reach.

# 9 Final establishments

## 9.1 Guarantee conditions

Guarantee conditions abide by terms and conditions of your distributor.

## 9.2 Safe disposal of the product after the service life

Hire a professional service to dispose of the hot tub after it reaches the end of its longevity. According to the WEEE directive (Electronics and electrical appliances waste) this device cannot be disposed of like a regular waste.

## 9.3 Warranty claims and repair services

Potential warranty claims abide by the consumer protection laws and the warranty claims policy of your distributor.



## 10 Repair services chart

**A TABLE FOR YOUR NOTES, PLEASE FILL OUT THE FOLLOWING INFORMATION. You will need the filled out information in case of a repair requested through the customer service line.**

<b>Purchase date</b>	
<b>Delivery date</b>	
<b>Model name</b>	
<b>Serial number</b>	
<b>Seller information (name, phone number)</b>	

## 11 Supplements

### Setting to 1× 230 V

When setting to 1× 230 V, it is necessary to observe the cross-section of the supply wire; namely: CYKY – 3× 10. A circuit breaker 63 A and Residual Current protective Device 40 A type C or D, according to the applicable standards of the country where the product is installed. This setting is necessary to maintain all functions of the tub.

### Illuminated cabinet

If you have a product with an illuminated cabinet (not illuminated corners) or extended casing and use a Bypass, it is always necessary to connect the external device by creating an opening in the cabinet, as it cannot be routed through the bottom.





**HANSCRAFT**<sup>®</sup>  
european spa producer

last update: 13. 11. 2023

**HANSCRAFT, s.r.o.**

K Vodojemu 140

252 19 Chrástřany u Prahy

CZECH REPUBLIC

**[www.HANSCRAFT.eu](http://www.HANSCRAFT.eu)**



**Safety**

Regular

Production

Surveillance



[www.tuv.com](http://www.tuv.com)

ID 0000073072